

PROJECT: _____
 CATALOG #: _____
 FIXTURE TYPE: _____
 NOTES: _____

FSP PRO SERIES Sparta™ Sports Light Gen 1



The *FSP Sparta™ Sports Light Gen 1 Series* sets a new standard of technology for professional outdoor sport lighting. Unlike competitor products, the *FSP Sports Light* requires less power and produces greater lumen output while generating less heat to extend the life of the fixture. Movable parts are eliminated to reduce wear and tear and it's only a fraction of the weight from the competition. Engineered optics direct the light precisely onto the field to shine uniformly and reduce glare.

APPLICATIONS

Outdoor Sports Arenas

PERFORMANCE INFORMATION

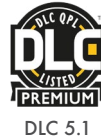

DLC 5.1

PRO Series			LARGE
SERIES NUMBER	WATT	LUMENS	CCT
FSP 900 3 G1 HVU 57K	650W	91,000	5700K
FSP 1150 3 G1 HVU 57K	850W	113,000	5700K
FSP 900 4 G1 HVU 57K	650W	88,000	5700K
FSP 1150 4 G1 HVU 57K	850W	112,000	5700K

OPTIONS



Wireless Control



Laser Guide



Black Top Visor



Silver Top Visor



TR-SP-B Tenon Adaptor

ORDERING GUIDE							EXAMPLE: FSP 900 3 G1 HVU 57K
Luminaire Type	Lumen Output	Distribution Type	Generation	Voltage	CCT	Finish	Options
FSP Pro Series Sparta Sports Light	900 88,000 Lumens 1150 112,000 Lumens	3 =NEMA 3 4 =NEMA 4	G1	HVU = 240-480V	40K 4000K* 50K 5000K* 57K 5700K	BLANK = Black	BLANK =Laser Guide & Black Top Visor SW =SLG Wireless Control SV = Silver Top Visor TR-SP-B = Tenon Adaptor, Transform Yoke mount to Slipfitter

*Contact sales for availability.

Due to continuous product improvements, specification and/or equipment updates may change without notice.

SPECIFICATIONS

HOUSING

Solid-state die cast aluminum housing ensures no mobile pieces and provides maintenance-free operation for more than 10 years.

AMBIENT TEMPERATURE

Suitable for use in -40°C to 55°C (-40°F to 131 °F)

MOUNTING

Mounting bracket is included for a wide variety of applications.

EFFICACY

Up to 135 lumens per watt (see individual wattage data)

CCT AND CRI

4000K, 5000K, and 5700K CCT available; 70+CRI

OPTICS

Custom-engineered optics direct light precisely while reducing glare.

EPA

3.0

WARRANTY

10-year limited warranty. Comprehensive warranty terms can be located on www.slgus.com. 25-year warranty available by request. Call sales for more information.

ELECTRICAL

50/60Hz operation with 240-480V HVU input. Dimming 0-10V driver. Surge protector 10kA/20kV.

LIFE

100,000 Hour Life Span. Based on LM-80 Results.

FINISH

Polyester Powder finish for superior corrosion resistance and maximum durability.

CERTIFICATIONS

UL Listed for wet locations, IP65 rating. DesignLights Consortium® (DLC) Premium 5.1 qualified product. Not all versions of this product may be DLC qualified. Please visit www.slgus.com to confirm which versions are qualified.

DIMENSIONS

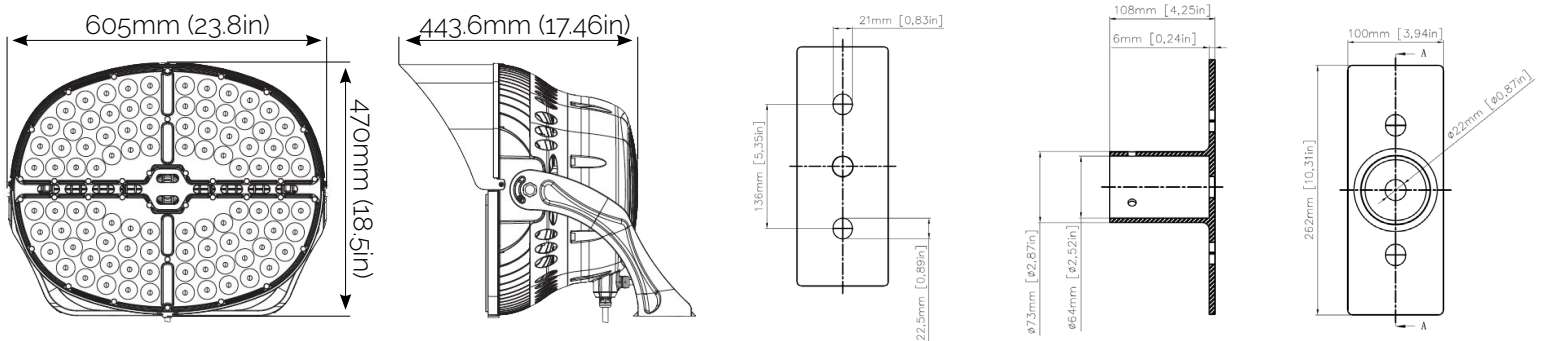

LARGE
650W/850W
Weight: 62 lbs
EPA: 3.0

Tenon Adaptor

Due to continuous product improvements, specification and/or equipment updates may change without notice.

PHOTOMETRIC DATA

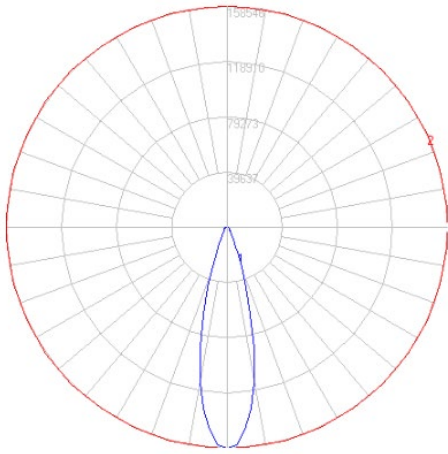

Polar Distribution NEMA 4

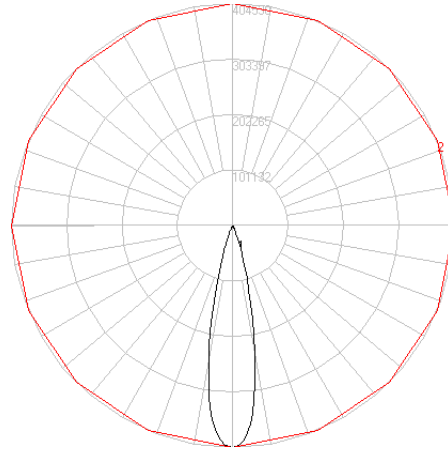

Polar Distribution NEMA 3

PERFORMANCE COMPARISON

Product Series	Wattage	Lumens	Efficacy (LPW)	Voltage	CCT
FSP 900 3 G1 HVU 57K	650W	91,000 Lm	140 Lm/W	240-480V	5700K
FSP 1150 3 G1 HVU 57K	850W	113,000 Lm	133 Lm/W	240-480V	5700K
FSP 900 4 G1 HVU 57K	650W	88,000 Lm	135 Lm/W	240-480V	5700K
FSP 1150 4 G1 HVU 57K	850W	112,000 Lm	132 Lm/W	240-480V	5700K

ELECTRICAL DATA

Wattage (W)	Current(A)					
	120V	208V	240V	277V	347V	480V
650W	N/A	N/A	2.7	2.35	1.87	1.35
850W	N/A	N/A	3.54	3.07	2.44	1.77

Due to continuous product improvements, specification and/or equipment updates may change without notice.

PROJECT: _____
 CATALOG #: _____
 FIXTURE TYPE: _____
 NOTES: _____

FSP REC SERIES Sparta™ Sports Light Gen 1



The *FSP Sparta™ Sports Light Gen 1 Series* sets a new standard of technology for professional outdoor sport lighting. Unlike competitor products, the *FSP Sports Light* requires less power and produces greater lumen output while generating less heat to extend the life of the fixture. Movable parts are eliminated to reduce wear and tear and it's only a fraction of the weight from the competition. Engineered optics direct the light precisely onto the field to shine uniformly and reduce glare.

APPLICATIONS

Recreational Sports, Parks, etc.

PERFORMANCE INFORMATION



REC Series

SMALL

SERIES NUMBER	WATT	LUMENS	CCT
FSP 500 4 G1 50K	350W	51,000	5000K
FSP 700 4 G1 50K	505W	70,000	5000K

OPTIONS



ORDERING GUIDE							EXAMPLE: FSP 500 4 G1 50K
Luminaire Type	Lumen Output	Distribution Type	Generation	Voltage	CCT	Finish	Options
FSP Rec Series Sparta Sports Light	500 51,000 Lumens 700 70,000 Lumens	4 =NEMA 4	G1	BLANK = 120-277V HVU = 347-480V	40K 4000K* 50K 5000K	BLANK = Black	BLANK =Laser Guide & Black Top Visor SW =SLG Wireless Control TR-SP-B = Tenon Adaptor, Transform Yoke mount to Slipfitter TR-SP-B-MP = Tenon Adaptor Mounting Plate. Works with Tenon adaptor (Required)

*Contact sales for availability.

Due to continuous product improvements, specification and/or equipment updates may change without notice.

SPECIFICATIONS

HOUSING

Solid-state die cast aluminum housing ensures no mobile pieces and provides maintenance-free operation for more than 5 years.

AMBIENT TEMPERATURE

Suitable for use in -40°C to 55°C (-40°F to 131 °F)

MOUNTING

Mounting bracket is included for a wide variety of applications.

EFFICACY

Up to 146 lumens per watt (see individual wattage data)

CCT AND CRI

4000K and 5000K CCT available; 70+CRI

OPTICS

Custom-engineered optics direct light precisely while reducing glare.

EPA

2.1

WARRANTY

5-year limited warranty. Comprehensive warranty terms can be located on www.slgus.com.

ELECTRICAL

50/60Hz operation with 120-277V input. HVU option available. Dimming 0-10V driver. Surge Protector 5KA/10KV for 120-277V, 10KA/20KV for 347-480V.

LIFE

More than 70,000 Hour Life Span. Based on LM-80 Results.

FINISH

Polyester Powder finish for superior corrosion resistance and maximum durability.

CERTIFICATIONS

UL Listed for wet locations, IP65 rating. DesignLights Consortium® (DLC) Premium 5.1 qualified product. Not all versions of this product may be DLC qualified. Please visit www.slgus.com to confirm which versions are qualified.

DIMENSIONS

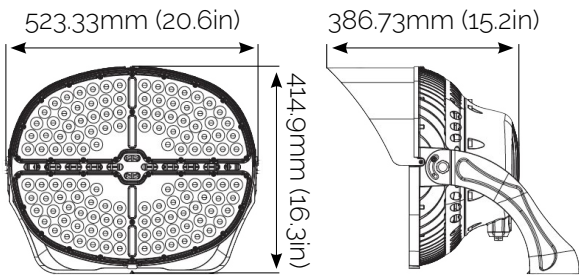

SMALL
350W/505W
Weight: 38 lbs
EPA: 2.1

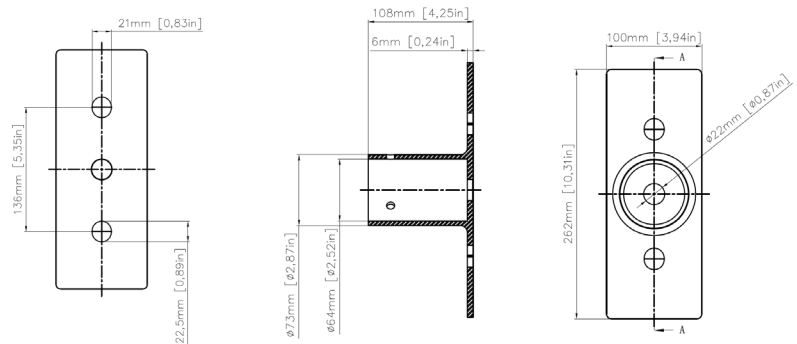

Tenon Adaptor

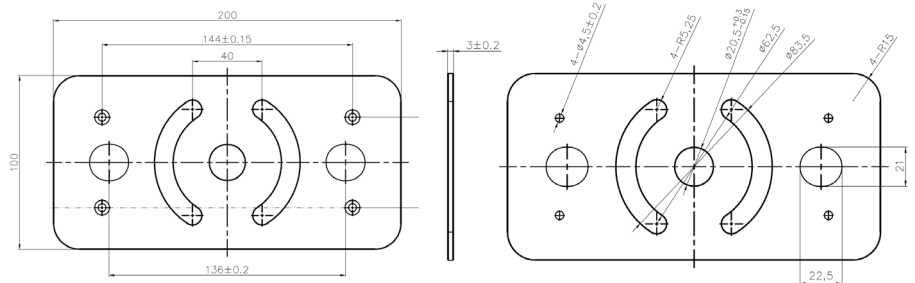

Mounting Plate

Due to continuous product improvements, specification and/or equipment updates may change without notice.

PHOTOMETRIC DATA

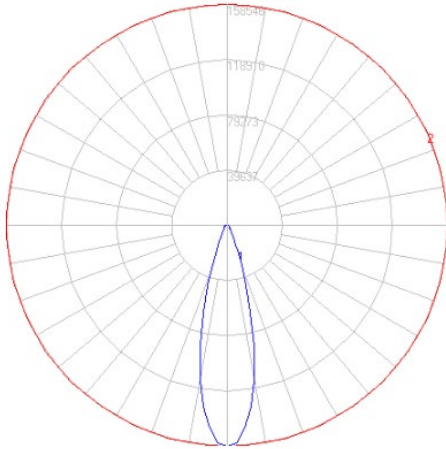

Polar Distribution NEMA 4

PERFORMANCE COMPARISON

		5000K		
Product Series	Wattage	Lumens	Efficacy (LPW)	Voltage
FSP 500 4 G1	350W	51,000 Lm	146 Lm/W	120-277V
FSP 700 4 G1	505W	70,000 Lm	139 Lm/W	120-277V
FSP 500 4 G1 HVU	350W	51,000 Lm	146 Lm/W	347-480V
FSP 700 4 G1 HVU	505W	70,000 Lm	139 Lm/W	347-480V

ELECTRICAL DATA

Wattage (W)	Current(A)					
	120V	208V	240V	277V	347V	480V
350W	2.84	1.64	1.42	1.23	0.98	0.71
505W	4.21	2.43	2.11	1.83	1.46	1.06

Due to continuous product improvements, specification and/or equipment updates may change without notice.